

Product Image

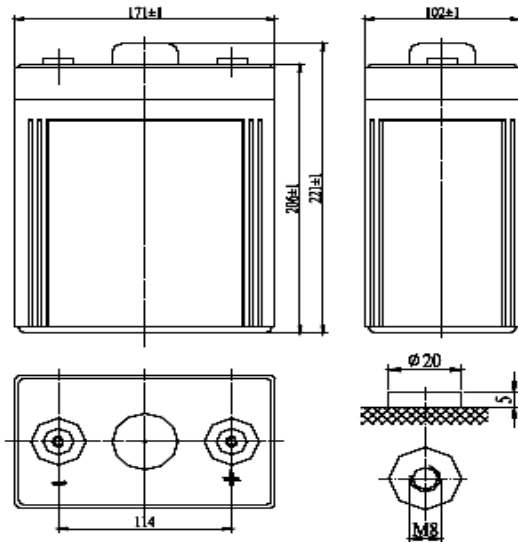

Product Dimensions



Characteristics

| | | |
|---|---------------------------|--|
| Nominal Voltage | | 2V |
| Nominal Capacity (10 hour rate) | | 160Ah |
| Capacity 25°C (77°F) | 20 hour rate (8.5A) | 170Ah |
| | 5 hour rate (28.3A) | 141.5Ah |
| | 1 hour rate (88A) | 88Ah |
| Internal Resistance | Full Charged Battery 25°C | ≤1.5mΩ |
| Capacity affected by Temperature (10 hour) | 40°C (104°F) | 102% |
| | 25°C (77°F) | 100% |
| | 0°C (32°F) | 85% |
| | -15°C (5°F) | 65% |
| Self-Discharge 25°C (77°F) Capacity | after 3 month storage | 90% |
| | after 6 month storage | 80% |
| | after 12 month storage | 62% |
| Charge (Constant Voltage) 25°C (77°F) | Float | Initial Charging Current Less than 32A Voltage 2.24-2.28V |
| | Cycle | Initial Charging Current Less than 32A Voltage 2.33-2.37V |

Packaging

| | | |
|-----------------------|-----------------|--------------|
| Battery Dimensions | Length | 171mm |
| | Width | 102mm |
| | Height | 206mm |
| | Total Height | 231mm |
| Box Dimensions | Length | 224mm |
| | Width | 187mm |
| | Height | 261mm |
| Quantity Per Box | | 2 PC per box |
| Net weight Per Cell | | 9.3 kg±200g |
| Net weight Per Box | | 18.6kg |
| Gross Weight | | 20.0kg |

Discharge Constant Current per Cell (Amperes at 77°F 25°C)

| F.V/Time | 5min | 10min | 15min | 30min | 45min | 1h | 2h | 3h | 5h | 8h | 10h | 20h |
|----------|-------|-------|-------|-------|-------|-------|------|------|------|------|------|-----|
| 1.60V | 462.4 | 297.3 | 247.7 | 165.1 | 118.4 | 102.1 | 45.1 | 44.0 | 29.9 | 19.7 | 17.6 | 9.3 |
| 1.65V | 453.9 | 291.8 | 243.2 | 162.1 | 116.3 | 100.2 | 44.2 | 43.2 | 29.4 | 19.4 | 17.3 | 9.2 |
| 1.70V | 445.6 | 286.4 | 238.6 | 159.0 | 114.1 | 98.4 | 43.4 | 42.4 | 28.8 | 19.0 | 17.0 | 9.0 |
| 1.75V | 437.1 | 281.1 | 234.1 | 156.2 | 112.0 | 96.5 | 42.6 | 41.6 | 28.3 | 18.6 | 16.6 | 8.8 |
| 1.80V | 420.3 | 270.2 | 225.1 | 150.1 | 107.7 | 92.8 | 41.0 | 40.0 | 27.2 | 17.9 | 16.0 | 8.5 |

Discharge Constant Power per Cell (Watts at 77°F 25°C)

| F.V/Time | 5min | 10min | 15min | 30min | 45min | 1h | 2h | 3h | 5h | 8h | 10h | 20h |
|----------|-------|-------|-------|-------|-------|-------|------|------|------|------|------|------|
| 1.60V | 890.1 | 572.2 | 476.6 | 317.8 | 228.0 | 196.5 | 86.7 | 84.6 | 57.6 | 37.9 | 33.9 | 17.9 |
| 1.65V | 873.9 | 561.8 | 468.0 | 312.0 | 223.8 | 193.0 | 85.1 | 83.2 | 56.5 | 37.3 | 33.3 | 17.6 |
| 1.70V | 857.6 | 551.4 | 459.4 | 306.2 | 219.7 | 189.3 | 83.5 | 81.6 | 55.5 | 36.6 | 32.6 | 17.3 |
| 1.75V | 841.4 | 541.0 | 450.7 | 300.5 | 215.5 | 185.8 | 82.1 | 80.2 | 54.4 | 35.8 | 32.0 | 17.0 |
| 1.80V | 809.1 | 520.2 | 433.3 | 289.0 | 207.4 | 178.7 | 78.9 | 77.0 | 52.3 | 34.6 | 30.9 | 16.3 |

Note The above data are average values, and can be obtained within 3 charge/discharge cycles. These are not minimum values. Cell and battery designs/specifications are subject to modification without notice. Contact **US** for the latest information.

Performance Characteristics

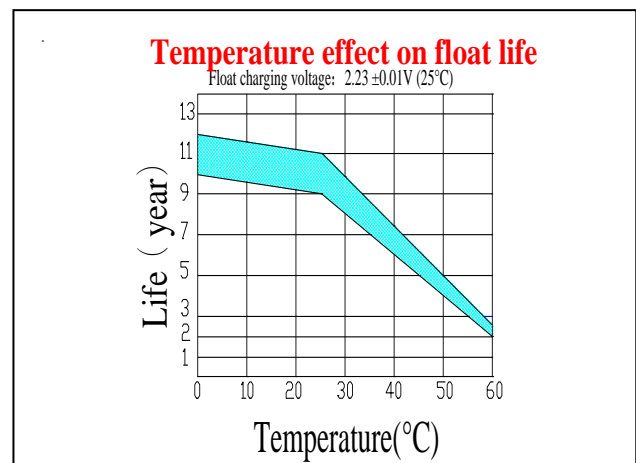
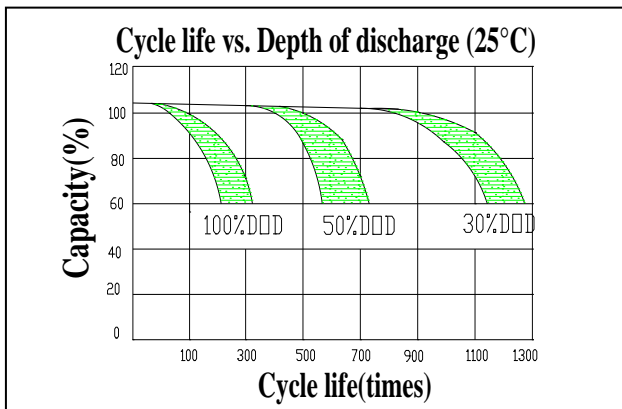
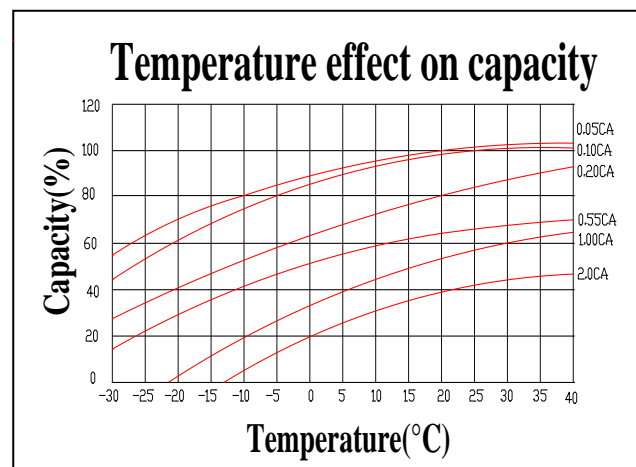
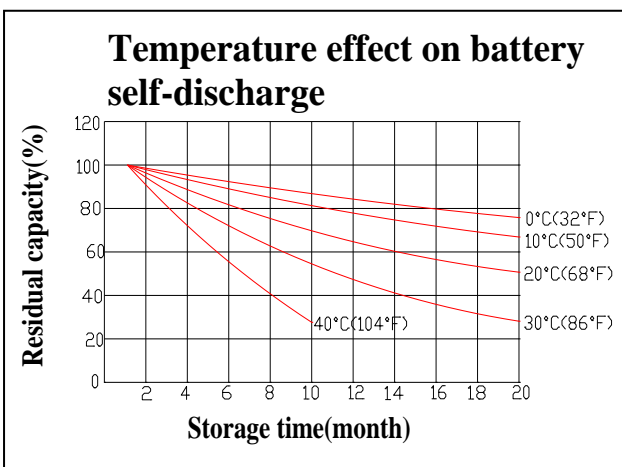
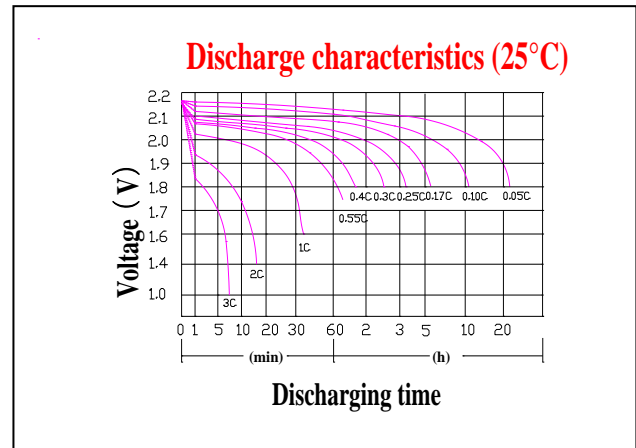
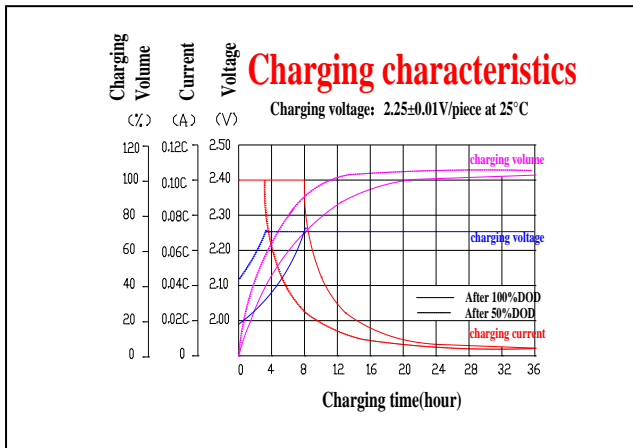

Battery Construction

| Component | Positive plate | Negative plate | Container | Cover | Safety valve | Terminal | Separator | Electrolyte |
|--------------|----------------|----------------|-----------|-------|--------------|----------|------------|---------------|
| Raw material | Lead dioxide | Lead | ABS | ABS | Si-Rubber | Lead | Fiberglass | Sulfuric acid |

Guangdong JiYi General Electric Co., Ltd.

Overseas sales office Tel: +86-020-84869873 Fax: +86-020-34628335

Domestic sales office Tel: 020-34628335 Fax: 020-34628335

E-mail: ge@gerch.cn