

Product Image

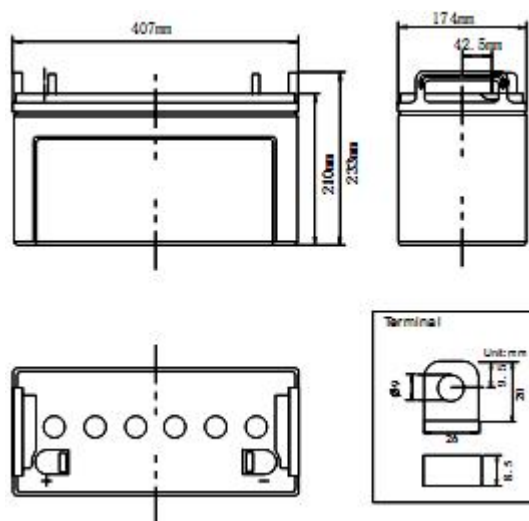

Product Dimensions



Characteristics

Nominal Voltage		12V
Nominal Capacity (10 hour rate)		134Ah
Capacity 25°C (77°F)	20 hour rate (7.2A)	144.3Ah
	5 hour rate (23.8A)	119.0Ah
	1 hour rate (86.5A)	73.7Ah
Internal Resistance	Full Charged Battery 25°C	≤5.0m Ω
Capacity affected by Temperature (10 hour)	40°C (104°F)	102%
	25°C (77°F)	100%
	-20°C (-4°F)	82%
	-35°C (-31°F)	65%
Self-Discharge 25°C (77°F) Capacity	after 3 month storage	90%
	after 6 month storage	80%
	after 12 month storage	62%
Charge (Constant Voltage) 25°C (77°F)	Float	Initial Charging Current Less than 33.5A Voltage 13.6-13.8V
	Cycle	Initial Charging Current Less than 33.5A Voltage 14.4-14.9V

Packaging

Battery Dimensions	Length	341mm
	Width	174mm
	Height	281mm
	Total Height	288mm
Box Dimensions	Length	360mm
	Width	188mm
	Height	296mm
Quantity Per Box		1 PC per box
Net weight Per Cell		41.50kg±400g
Net weight Per Box		41.50kg
Gross Weight		42kg

Discharge Constant Current per Cell (Amperes at 77°F 25°C)

F.V/Time	5min	10min	15min	30min	45min	1h	2h	3h	5h	8h	10h	20h
1.60V	387.26	248.97	207.43	138.29	99.16	85.49	37.79	36.85	25.06	16.48	14.74	7.81
1.65V	380.16	244.42	203.68	135.74	97.42	83.88	36.98	36.18	24.66	16.21	14.47	7.66
1.70V	373.19	239.86	199.79	133.20	95.54	82.41	36.31	35.51	24.12	15.95	14.20	7.53
1.75V	366.09	235.44	196.04	130.78	93.80	80.80	35.64	34.84	23.72	15.54	13.94	7.38
1.80V	352.02	226.33	188.54	125.69	90.18	77.72	34.30	33.50	22.78	15.01	13.40	7.10

Discharge Constant Power per Cell (Watts at 77°F 25°C)

F.V/Time	5min	10min	15min	30min	45min	1h	2h	3h	5h	8h	10h	20h
1.60V	745.44	479.18	399.19	266.12	190.95	164.55	72.63	70.89	48.24	31.76	28.41	15.01
1.65V	731.91	470.47	391.95	261.30	187.47	161.60	71.29	69.68	47.30	31.22	27.87	14.74
1.70V	718.24	461.76	384.71	256.48	183.98	158.52	69.95	68.34	46.50	30.69	27.34	14.47
1.75V	704.71	453.05	377.48	251.65	180.50	155.57	68.74	67.13	45.56	30.02	26.80	14.20
1.80V	677.64	435.63	362.87	242.00	173.66	149.68	66.06	64.45	43.82	28.94	25.86	13.67

Note The above data are average values, and can be obtained within 3 charge/discharge cycles. These are not minimum values. Cell and battery designs/specifications are subject to modification without notice. Contact **US** for the latest information.

Performance Characteristics

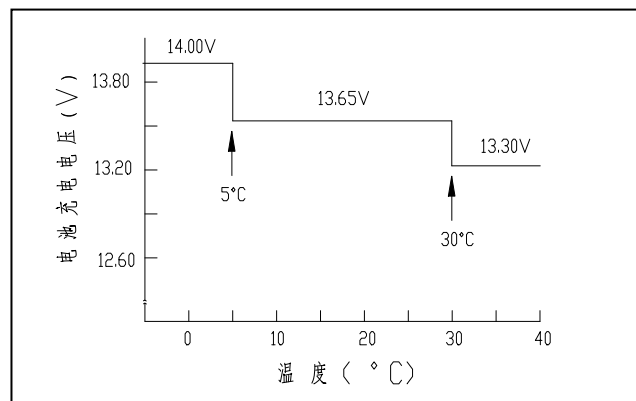
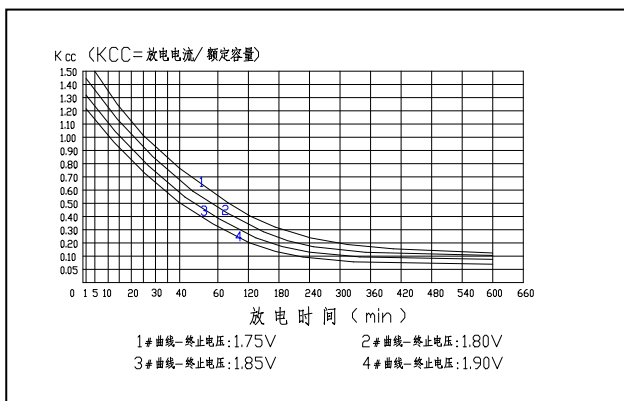
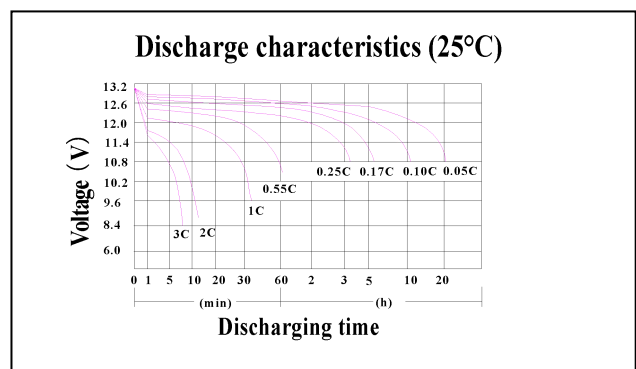
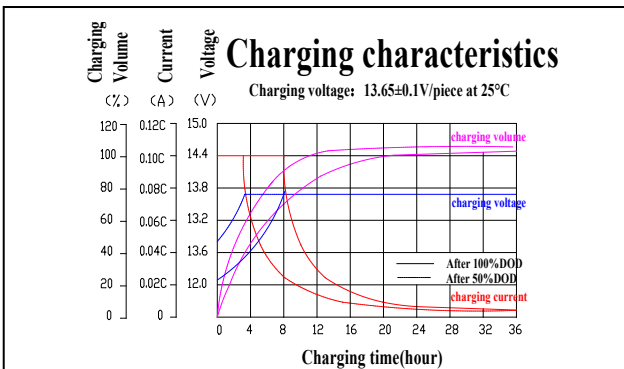
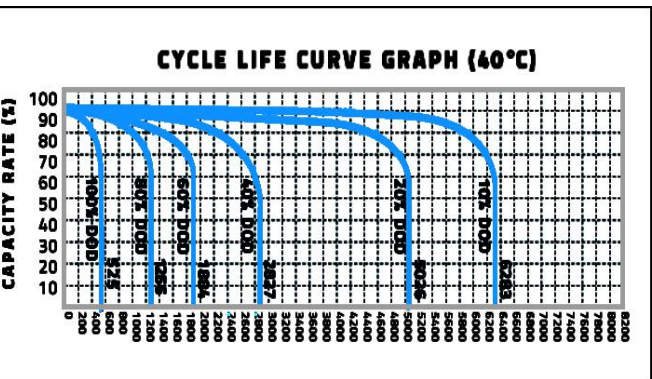
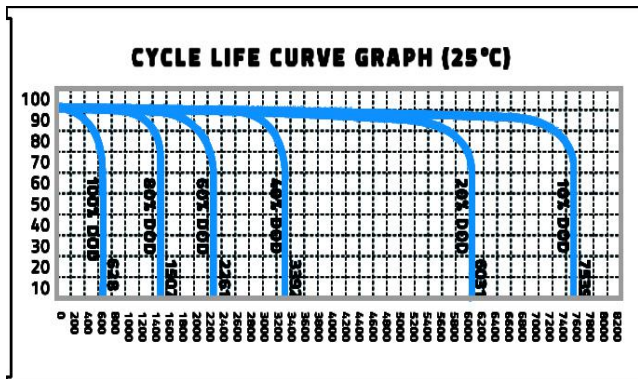
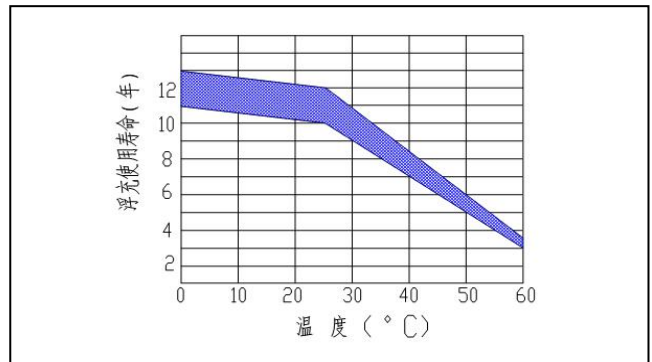
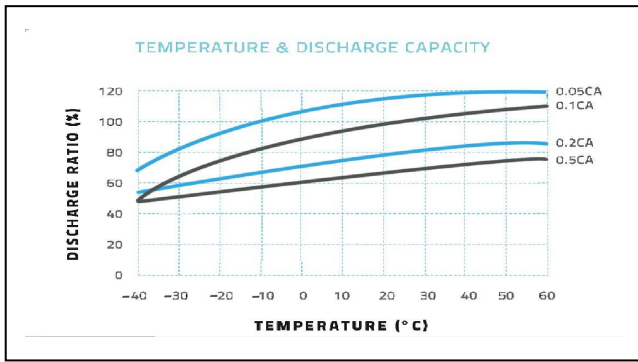

Battery Construction

Component	Positive plate	Negative plate	Container	Cover	Safety valve	Terminal	Separator	Electrolyte
Raw material	Lead dioxide	Lead	ABS	ABS	Si-Rubber	Copper	Fiberglass	Lead

Guangdong JiYi General Electric Co., Ltd.

Overseas sales office Tel: +86-020-84869873

Fax: +86-020-34628335

Domestic sales office Tel: 020-34628335

Fax: 020-34628335

E-mail: ge@gerch.cn